



art metal

# 26 AURELIA

F.P.H. Art Metal Sp.j.

Ul. Jabłoniowa 124, 83-331 Łapino Kartuskie, Poland  
Tel. 0048 58 681 80 78, Fax: 0048 58 681 80 64  
www.art-metal.pl e-mail: biuro@art-metal.pl

### Construction:

The luminaire consists of a body (1) and the shade (2) mounted by the ring (3). A roof (4) is mounted to the ring. Ignitor (5) is placed under bottom reflector (6) in a body (1). The light source is mounted with a ceramic lamp holder (7). The tightness of the luminaire ensure the seals (8).

### Mounting instructions:

- Make electrical connections in accordance with the markings. Tighten the cable glands.
- Mount the reflector (6) on the ignitor (5) and light source in a lamp holder (7)
- Assemble the shade (4), sealers (8) and then the roof (4) with a cover
- Tighten the nuts (9) by hand
- The luminaire is designed to be mounted on a pole (diameter 60 – 90mm).

If any lantern elements are supplied factory-mounted, the mounting stages marked with \* should be omitted (as this has already been done by the manufacturer)

### TECHNICAL DATA:

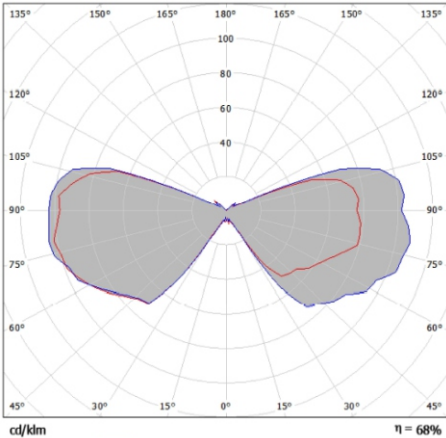

Power: ~230/50Hz

Protective class: I

IP66 -electrical part

IP66 -optical part

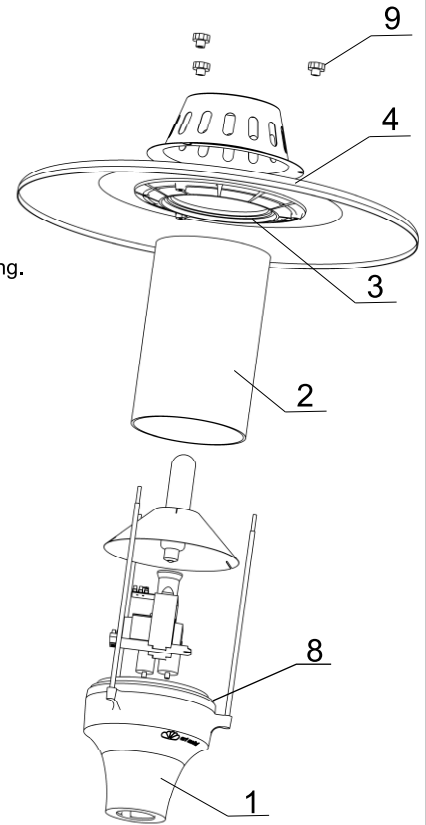
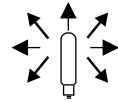
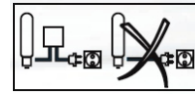
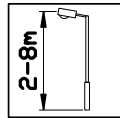

### ELECTRICAL DIAGRAM:

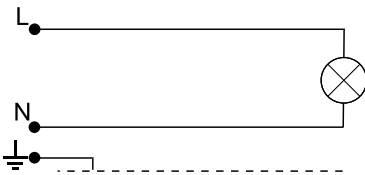

1. Incandescent bulb

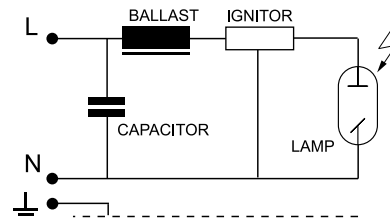

2. Sodium / metal halide lamps

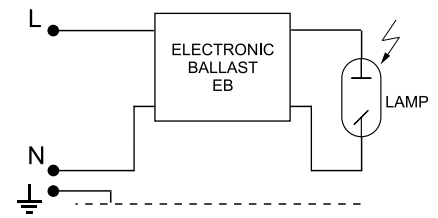

3. Sodium / metal halide lamps

Type	Light-producing element	Lamp holder	Weight [kg]	Pn [W]		Luminary dimensions	
				IC	EB		
26MH-70W	MH/HSI/HPI	E27	7,9	81	78		
26MH-100W	MH/HSI/HPI	E27	8,3	114	109		
26MH-150W	MH/HSI/HPI	E27	9,2	169	164		
26S-70W	WLS/SHP/SON	E27	7,9	81	78		
26S-100W	WLS/SHP/SON	E40	8,4	114	109		
26S-150W	WLS/SHP/SON	E40	9,3	169	164		
26Z-E/Z	Bulb / MINI-LINX	E27	7,4	Max. 60			

**WARNING !!** The weight of the unit may slightly differ for individual production batches.

